

MAGIC MOTOR User Manual

V1.1 2015.12

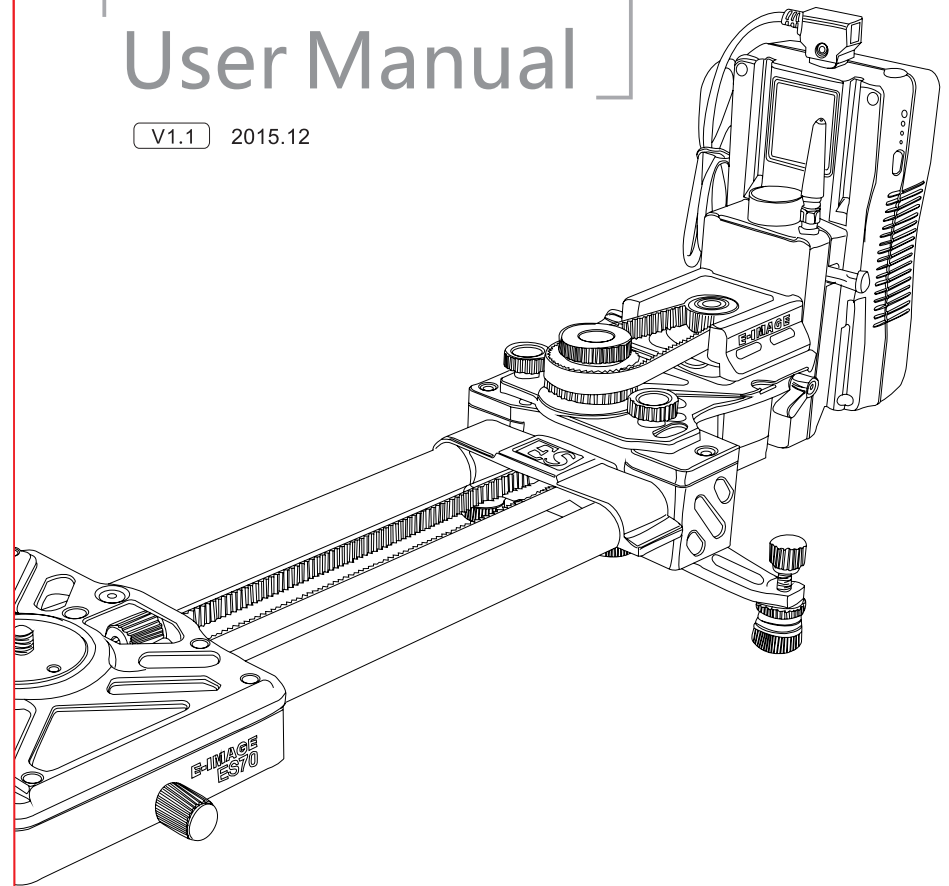

If any updates without prior notice!

You can visit our official website to check the newest user manual.
www.eimagevideo.com

E-image always make efforts to provide the best user manual. If you have any questions or suggestions about the manual.

Please contact us by : sales@eimagevideo.com

Disclaimers and Warnings

Thanks for choosing EIMAGE MAGIC MOTOR. Please make sure strictly observe according to this user manual.

Please read this manual and disclaimer carefully before using this product. By using this product, you hereby agree to this disclaimer and signify that you have read it fully. You agree that you are responsible for your own conduct and any content created while using this product, and for any consequences thereof. You agree to use this product only for purposes that are proper and in accordance with EIMAGE regulations, terms and any applicable policies and guidelines.

Do not modify or adjust the MOTOR. As EIMAGE has no control over use, setup, final assembly, modification or misuse, no liability shall be assumed or accepted for any resulting damage or injury. By the using, setting up, or assembling of the product, the user accepts all resulting liability. EIMAGE assumes no liability for damages or injuries incurred directly or indirectly from the use of this product.

There is a special page for Magic motor on Eimage official website: www.eimagevideo.com. please check if your user manual is the newest one, if not, please download and use the newest one.

This user manual if there is any updates without prior notice!

If you have any questions when you assembling the Motor, please ask help from the authorized agent of EIMAGE.

All names of products, brands, etc., appearing in this manual are trademarks or registered trademarks of their respective owner companies. This product and manual are copyrighted by EIMAGE, with all rights reserved. No part of this product or manual shall be reproduced in any form without the prior written consent or authorization of EIMAGE.

EIMAGE power using and safety precautions:

1. Please do not bare the equipment in the rain or be affected with damp, to avoid fire, electric shock accidents.
2. Do not close to the high magnetic field, medical, aircraft and other equipment, to avoid any interfere.
3. The power supply voltage need within 12 v and 24 v, it might damage the equipment higher than 24 v, or the equipment can not work properly less than 12 v.
4. For the power adapter, please make sure to choose the current more than 3A, Voltage should between 12-24V. If too lower, the motor can't work.
5. It will cause Equipment failure when using it in sand, dust and rain.
6. Don't change the emission frequency, and never use an external antenna or use other antenna.

6. Please use the voltage between 12 and 24 V, with a "V" lock batteries or use the power adapter connected to the household power, please guarantee the power is enough before using when the power is low, please recharge in time, if cut off the power in the work, it might damage the equipment and the camera.
7. The motor light will go on when normal work. Electric alarm will remind you when the battery is low, and the motor will be locked to prevent the camera accidental fall, please replace the battery in time.
8. Please do not put hands in slider belt or motor synchronization belt to avoid injuries.
9. Never disassemble the equipment privately, use it roughly and knock the product.
10. Before boot, make sure to move the slider in the middle position, loosen the lock of slider.
11. Before use, please adjust the "speed and direction" knob back to zero.

Device Copyright Registration Clarify

If you use the EIMAGE Slider in first time, the App will occur following reminder:

"You are the first time to use EIMAGE SLIDER. In order to fight pirate edition, the APP will send unique identifier data of motor-Series No. to server for copy right registration. Please open network or connect to WIFI, make sure your mobile device could connect to the internet."

Please kindly click "confirm" for continuous using.

Download and install the EIMAGE MAGIC MOTOR APP

For Apple Users

Please download the "EIMAGE" App before Using the Magic motor. For Apple users, please search for "EIMAGE" on the App store then follow the instructions for IOS installation.

For Android Users

Please scan follow QR code then follow the instructions for Android installation.

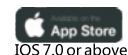

Contents

Disclaimers and Warnings	1
EIMAGE power using and safety precautions	1
Download EIMAGE App	2
Introduction	4
In the box	4
EIMAGE MOTOR diagram	6
Motor part	6
Wireless Remote Shutter Release	6
Assemble	7
Product assemble	7
Assemble notice	9
Download and install of the APP	11
Eimage Slider App	14
Trace record diagram	14
Motus diagram	14
Time-lapse	15
Stop-motion diagram	15
Parameter diagram	16
Professional vocabulary explanation	17
The main function demo	19
Precautions	19
Trace record	19
Motus	20
Time-lapse	21
Stop-motion	22
Wireless Remote Shutter	23
Operation Modes	24
Quiet Mode	24
Stable Mode	24
Force mode	24
Maintenance	24
Troubleshooting	25
Warranty and Support	25
Pirate Risk Statement	25
Specifications	27
Official QR code	28
Contact Informatron	28

Introduction

Ideal designed for professional filmmakers and photographers, the EIMAGE MAGIC MOTOR Slider marks a new generation of motor slider system. It features perfect stability, and more lightweight in the structure because of its successful design. App control system provides quick and convenient

operation during shooting. It can provide many functions, such as trace record, time-lapse and stop-motion functions.

E-IMAGE Magic Motor adopts a special motor, it works with position feedback and the IMU to communicate with E-IMAGE custom 32-Bit processor, which processes movement calculations in milliseconds, To ensure the slider precision is 0.0001 M, meaning that the camera will get perfectly steady shooting effect in any modes.

In the box

Motor part x1

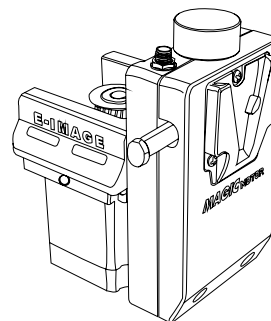

MP-01 Adapter Platex1(For Motor1)

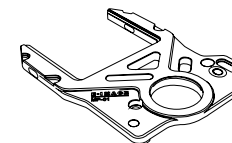

MP-02 Adapter Platex1(For Motor2)

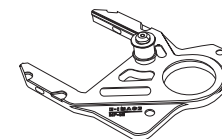

It built in EIMAGE motor drive modules, an independent IMU module, a 32-bit DSP processor power supply module, a Bluetooth module, a wireless module and a power breakout box.

Adapter plate locking knobx2



Used for fixing the adapter plate on the slide.

Synchronous belt x1

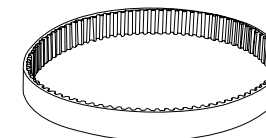

Through the synchronous belt, transfer the motion of the motor to track.

Synchronous locking knob x1

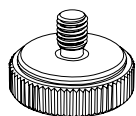

Connect the slider and the synchronous bel.

Synchronous wheels x1

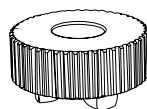

Fix the synchronous wheel.

Antenna x1



Receive the APP or the joystick signal.

Wireless Shutter x1



Receive the 2.4 G order, and then control camera shutter by cabels, and complete the whole process.

Safety box x1

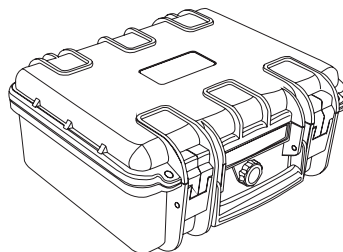

For protecting whole set motor, and to achieve convenient transportation.

Cable release x1

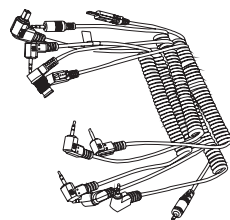

Transfer the instructions from wireless shutter to camera.

Extra accessories

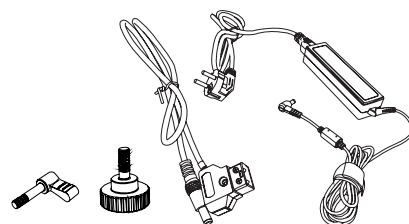

1pc-Motor locking knob
1pc-Adapter plate locking knob
1pc-DC cable to connect battery with motor
1pc-Power adapter

E-image Magic Motor Diagram

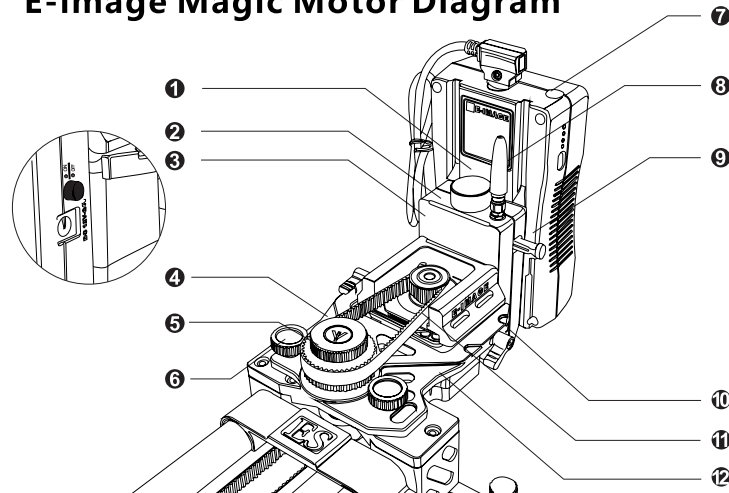

1.Motor main body

- | | |
|----------------------------------|------------------------------|
| 1. The speed and direction knob | 7. Battery |
| 2. The Motor body | 8. Antenna |
| 3. Power switch | 9. Battery release button. |
| 4. Synchronous locking knob | 10. Motor locking knob |
| 5. synchronous wheels | 11. Synchronous belt |
| 6. Connection plate locking knob | 12. MP - 01 connection plate |

2.WirelessShutter



WirelessShutter

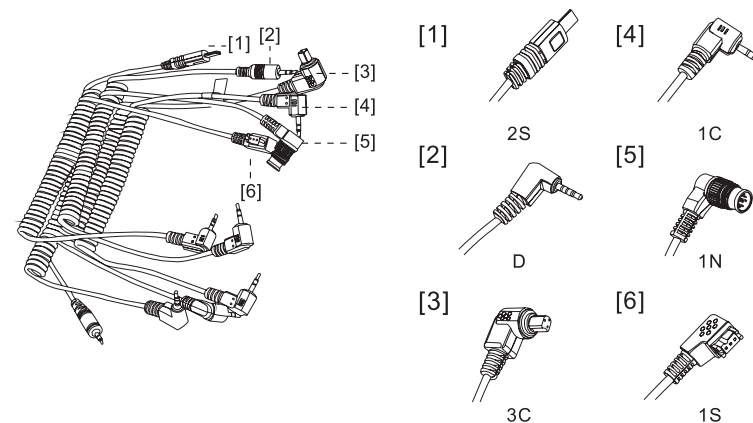

Assembling of Motor 1 (For ES70/90/120 Slider)

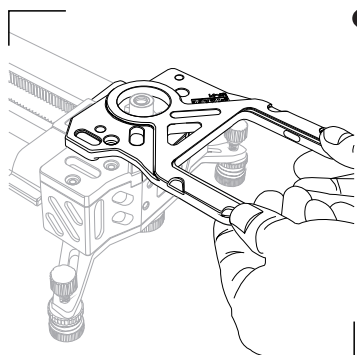

Insert the adapter plate on groove of the slider as the picture shows, please make sure the connection plate should exactly aimed at the hole and the grooves.

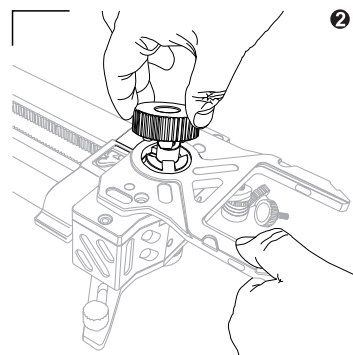

Fix the synchronous wheel on the slider by inserting three grooves closely.

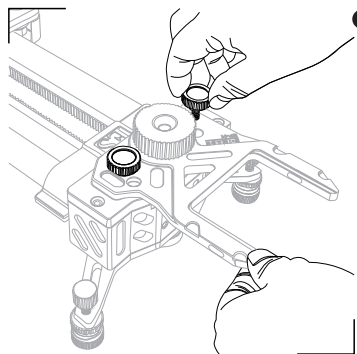

Insert the adapter plate locking screws and fixed the plate.

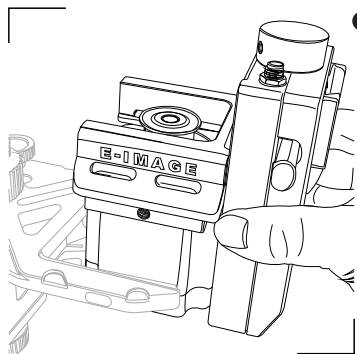

Put the motor body on the connection plate as the picture shows.

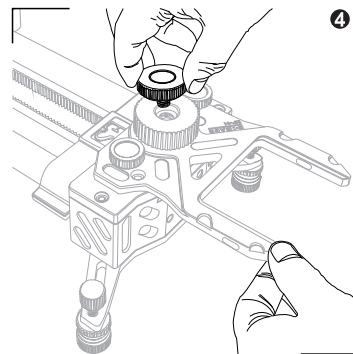

Attach synchronous wheel locking knob on the wheel and tighten the screw by clockwise.

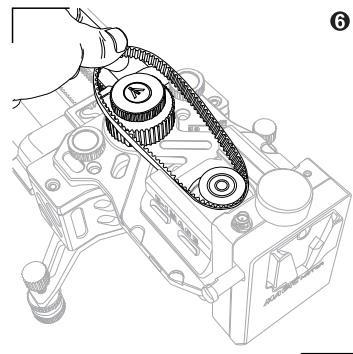

Buckle the one end of Synchronous belt to the Synchronous wheels of Motor body, and then adjust another end to the Synchronous wheels of slider.

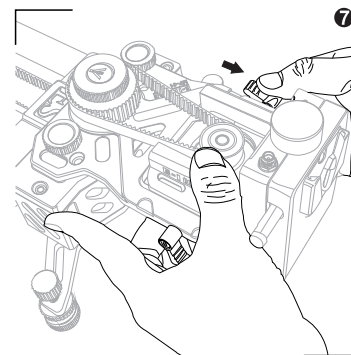

Pulling the motor part, adjust the Synchronous belt to tight state. Then assemble locking knob on two sides as picture showed and lock them.

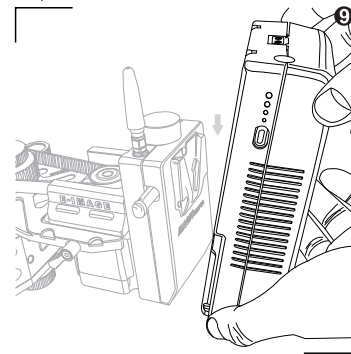

Install the battery to motor body with the v-lock.

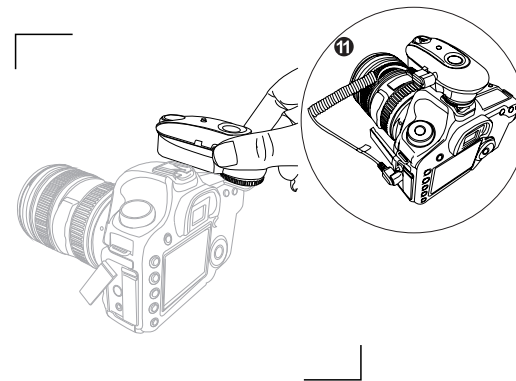

Insert the shutter to the camera's hot shoe base and connecting cable release.

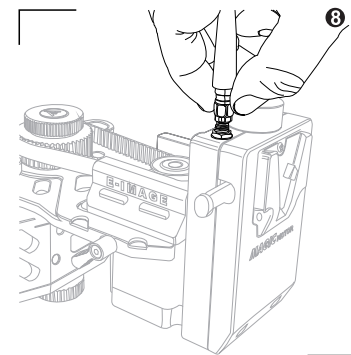

Assemble antenna to the antenna base by clockwise.

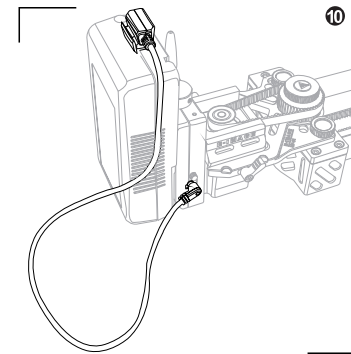

Connect the power cord with battery and the motor.

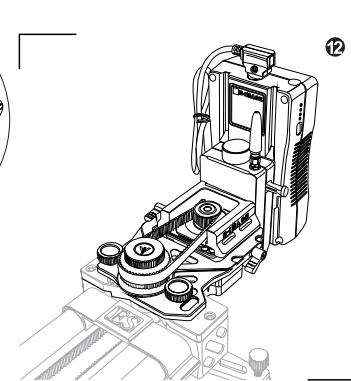

Finish

Assembling of Motor 2(For ED360 Ground Slider)

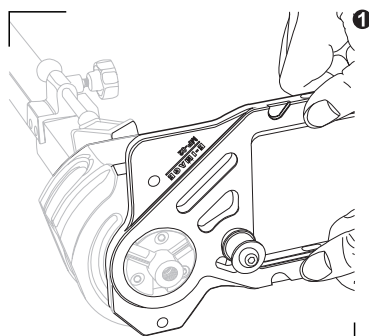

Insert the adapter plate on groove of the slider as the picture shows, please make sure the connection plate should exactly aimed at the hole and the grooves.

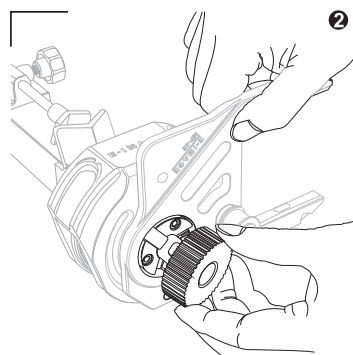

Fix the synchronous wheel on the slider by inserting three grooves closely.

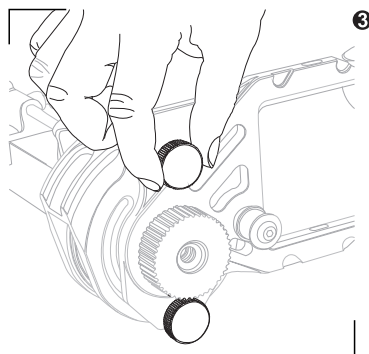

Insert the adapter plate locking screws and fixed the plate.

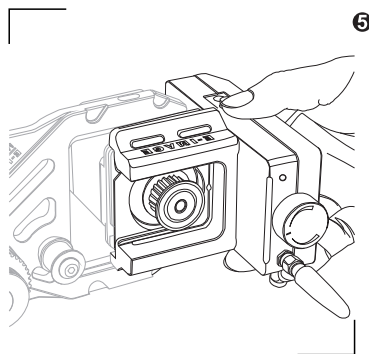

Put the motor body on the connection plate as the picture shows.

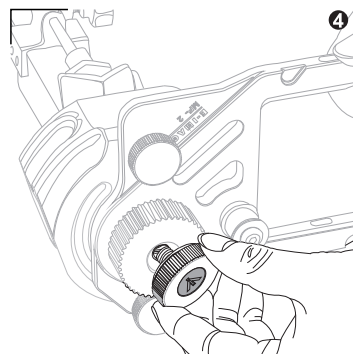

Attach synchronous wheel locking knob on the wheel and tighten the screw by clockwise.

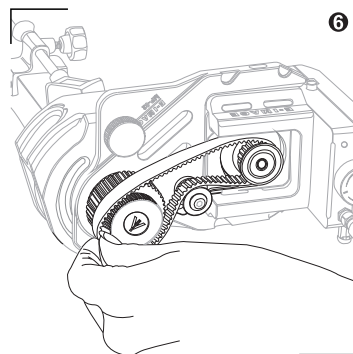

Buckle the one end of Synchronous belt to the Synchronous wheels of Motor body, then adjust another end to the Synchronous wheels of slider.

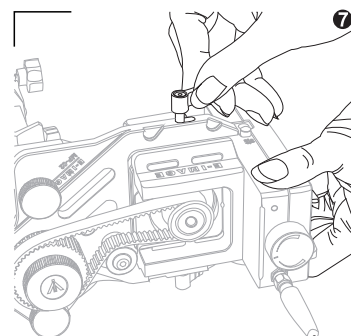

Pulling the motor part, adjust the Synchronous belt to tight state. Then assemble locking knob on two sides as picture showed and lock them.

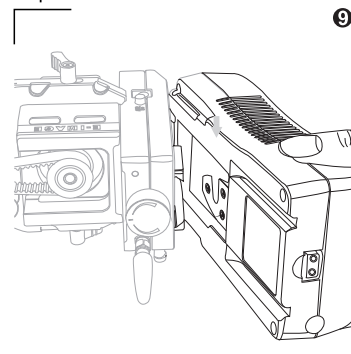

Install the battery to motor body with the v-lock.

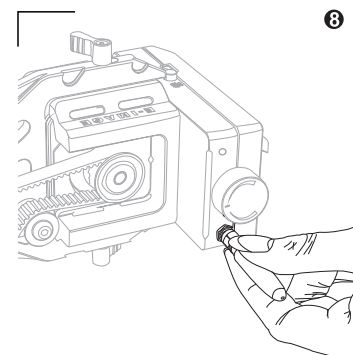

Assemble antenna to the antenna base by clockwise.

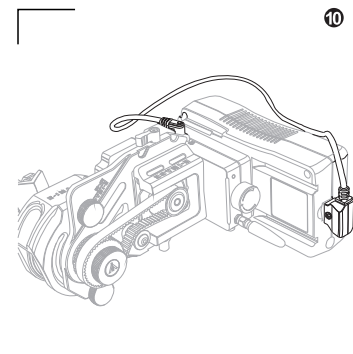

Connect the power cord with battery and the motor.

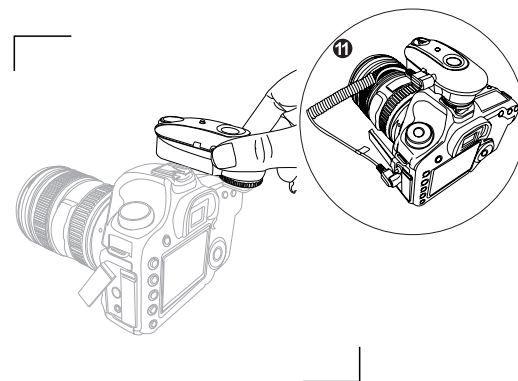

Insert the shutter to the camera's hot shoe base and connecting cable release.

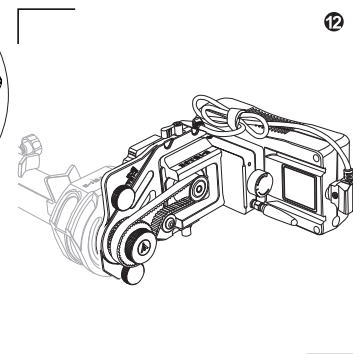

Finish

Installation Notes

1. After installing battery and power on, please check if the motor could work normally by turning the "Speed and direction" knob. If works normally, please back the "Speed and direction" knob to zero position, wait for using.
2. Please ensure that the motor power is shut off during installation.
3. Please choose shutter release according to your camera.
4. Before use, please ensure the synchronous belt is tight enough, so that the movement of the motor can be transferred to the slider precisely.

Download and install of the APP

Download and install

1. please scan the bellow QR code to download and install.



IOS 7.0 or above

2. Turn on Bluetooth and search the "EIMAGE SLIDER" and "Pair" with it.
3. Open the EIMAGE App, click "Device", then click "EIMAGE SLIDER".

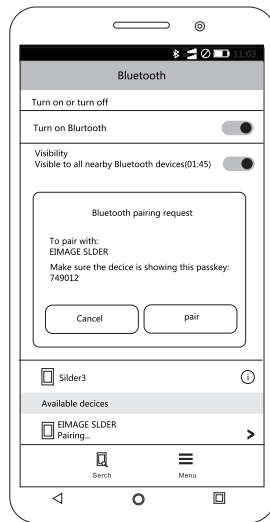

2

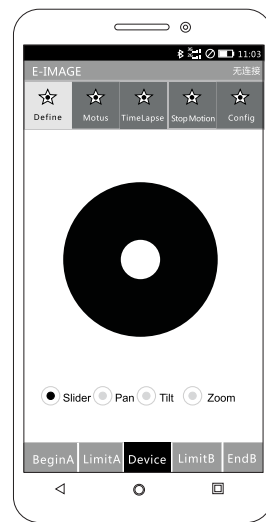

3

4. There are many devices, please find "EIMAGE SLIDER" and click it.
5. After successful connection, in the upper right, there will show "connect to EIMAGE SLIDER".

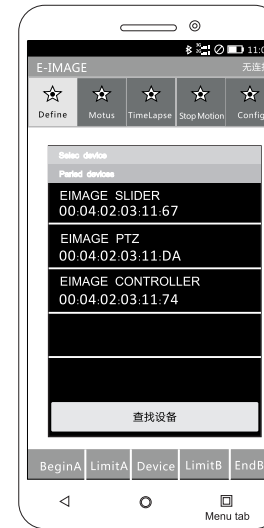

4

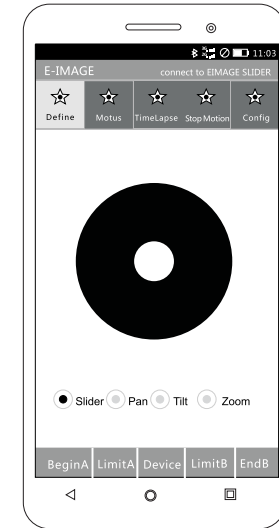

5

★ Note1: Some android phones will appear two names, please select the one with the phone logo or don't choose the one with "?".

★ Note2: In some Android phones, there will appear another two name of slider, such as:



Please choose the below.

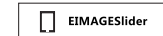

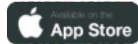

IOS 7.0 or above

Apple users:

- (1) please search for "EIMAGE" on the App store then follow the instructions for IOS installation.
- (2) Scan the below QR code to find "EIMAGE" on the App store then follow the instructions for IOS installation.

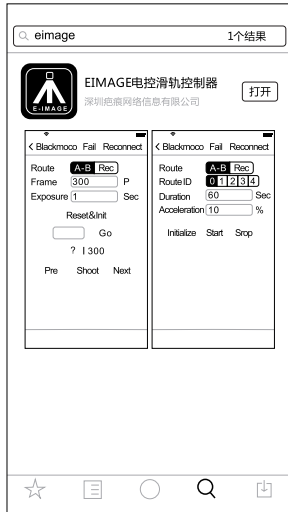

iOS 7.0以上

- Switch on the power of Motor, open the blue tooth of your mobile device. Then open the EIMAGE App, click "E", choose "EIMAGE SLIDER", then connect it.



EIMAGE SLIDER APP

Define

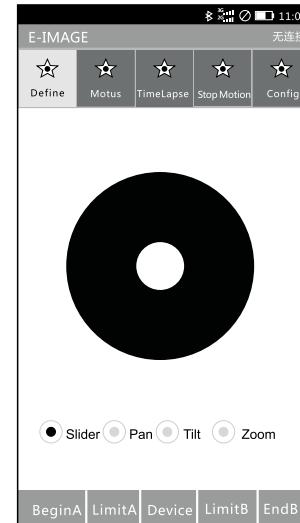

Navigator area

Control area

Center circle - on behalf of the Joystick, which can control the movement of camera: positive or negative direction movement. Center position - means stop, far away from center position, the speed will be faster. Loose finger, the center circle could be return to center position automatically.

Channel Settings area

Slider - control movement of Slider in Horizontal direction
Pan - control movement of PTZ in Horizontal direction
Tilt - control movement of PTZ in tilt direction
Zoom - Control camera lens zoom

The beginning/Ending point and the limit switch area

Limit A - Set Limit A

Limit B - Set Limit B

The camera will stop automatically when it run to switch A or B position, avoiding any bump, for safety insurance.

(When AB points are all set up, the character "Slider" will change color from black to red.)

Begin A - set beginning point A

End B - set the Ending point B

Set AB point as the moving trace.

Motus

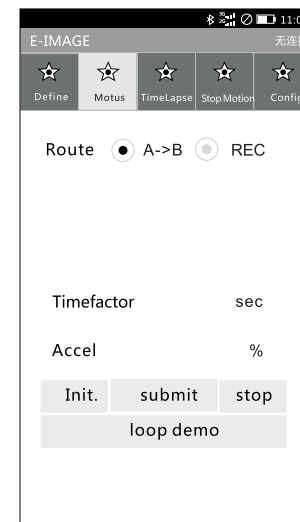

REC: trace record^③, applied to complex track record.

But complicated trace record only can be finished by wireless remote controller (optional).

ROUTE ID: 0, 1, 2, 4-5 Max: 5 routes. Following options will appear when click the REC

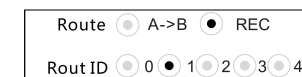

Time: setting the rough shooting time from begin point A to end point B.

Acceleration

Init: Let the camera back to the Begin point A

Submit: make the camera move to End B according to your set time and acceleration

Stop: Stop movement

Loop: let the camera do the cycling run between AB points

Time-lapse

Route - A - B: Begin point A to End point B, please set the A-B route in Define interface.

Route ☐ A->B ☒ REC
Route ID ☐ 0 ☒ 1 ☐ 2 ☐ 3 ☐ 4

REC: trace record, applied to complex track record. But complicated trace record only can be finished by wireless remote controller (optional).
ROUTEID: 0,1,2 4-5 Max:5 routes. Following options will appear when click the REC

----- Picture quantity that you want to shoot

----- The camera's ^⑤exposure time

----- End time of time-lapse

----- Spacing^⑥ proportion

----- Waiting time before exposure

----- Movement time

----- **Init:** Let the camera back to the Begin point A

----- **Submit:** (make the camera shoot according to set parameters.)

----- **Stop:** The movement of camera
For checking the current shooting process

Stop-Motion

----- The quantity you want to shoot

----- The camera's exposure time

----- Submit (make the camera shoot according to set parameters.)

----- Stop shooting

Config

----- Used to set the maximum speed of joystick
----- Set the maximum speed of slide
----- Set the maximum speed of PTZ in X axis
----- Set the maximum speed of PTZ in Y axis
----- Set the maximum adjust speed of camera zoom

----- Used to set the acceleration
----- Set the maximum acceleration of the slider
----- Set the maximum acceleration of PTZ in X axis
----- Set the maximum acceleration of PTZ in Y axis
----- Set the maximum acceleration of camera zoom

----- Used to set the direction of joystick in CONTROLLER
----- Slider: Positive/against
----- Horizontal direction: Positive/ negative
----- Vertical direction: Positive/ negative
----- Lens zoom: Positive/ negative

----- Used to set the direction of joystick in APP
----- Slider: Positive/against
----- Horizontal direction: Positive/ negative
----- Vertical direction: Positive/ negative
----- Lens zoom: Positive/ negative

----- Joystick stop range^⑦

----- Joystick acceleration
----- Set the acceleration, to control the acceleration' s smooth or sharp: maximum acceleration means sharpest reaction, minium acceleration means smoothest reaction .

----- 2.4 G channel^⑧

----- Slider mode
----- Table-means for slider (ES70/90/120)
----- Ground-means for ground slider (ED360)
----- Motor parameters

----- Motor segmentation parameters
----- Set the speed and sound of the motor. The smaller number means faster speed, corresponding a little more sound . Bigger number means slower speed, the relative sound is low even near silence.

----- Operation Modes

Note: When you change mode, the Motor need to be restarted.

Professional vocabulary explanation

① Limit setting

Limit setting means set a maximum movement distance of the camera from left or right. The LIMIT A and LIMIT B can be set respectively.

★ Note: 1. It will be effective only when Limit A & Limit B are all set.

2. Previous limit set will be failed if Motor is restart. Please reset it.
3. when Limit A & Limit B are all set, the character "Slider" will change the color from black to red, which means limit setting is finished to avoid any accident during operation.
4. Before any operation please set "Limit A&B" at first.

② Set beginning point

Begin point A and end point B represent the shooting start time and end time, (After setting, the character "Begin point A" and "End point B" will change the color from black to red. The set of Begin point A and end point B is effective for all current equipments synchronously).

③ Trace record

Complicated trace only can be recorded by optional wireless remote controller. After trace record is finished, you will find there are at most 5 routes when you click the "REC". Please choose the Route ID to do your following operations.

④ Acceleration

Lower acceleration number means the response action of motor is gentle, for example, if the joystick back to the central point (means stop), the response action of motor is reduce speed slowly until stop. If acceleration number is max., the response action of motor is stopped immediately without any cushioning. Acceleration number of each direction could be set separately.

⑤ Exposure time

When camera is under M mode, the APP exposure time should be longer than the camera exposure time. For example, camera exposure time is 1/100 s, at this time the App exposure time should be equal or longer than 1/80 s. When camera is under B mode, the real exposure time is decided by APP, now, there is no special requirement for App exposure time.

⑥ Interval Rate

Interval Rate: used to set the interval between exposure and movement

Track: Previous set trace from A to B

Time-lapse working principle is as below

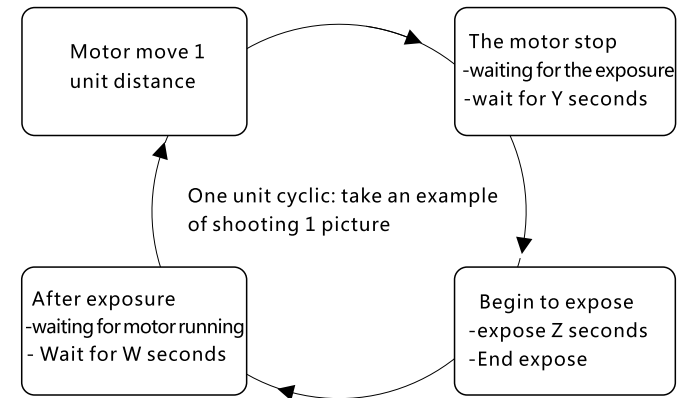

⑦ Joystick stop time

The stop range of joystick

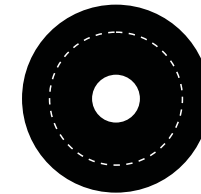

Example, Set at 50%, as shown in the picture, the dashed line range, if the joystick moves in this circle, the device won't move; once beyond the range then the camera will move.

⑧ 2.4G channel

Set the communication channel between different equipments: only Wireless shutter, slider, joystick and PTZ are all in same channel, then they could be communicated with each other. If there are multiple set of products used at the same time, in order to prevent communication channel confusion, please make a reference mark each set.

The main functions of EIMAGE Magic Motor

Attention

Pls pay attention to the following notes before operation:

1. Open the Bluetooth of mobile device, run software "EIMAGE APP", switch on the power of MAGIC MOTOR.
2. Connect the APP with your MAGIC Motor.
Note: During first using, first, please pair up "Magic Motor" with your Bluetooth options. APP will ask to open the Bluetooth of mobile device automatically when it is enabled, please click "YES".
Before operation, please set the maximum acceleration and max speed and related parameter in CONFIG page.
3. Please make sure the knob of speed and direction is on zero position before switching on the power.
Before record shooting, this button could be used to preview the movement first. After adjustment, please put it back to zero position, and waiting for next operations.
4. Please make sure battery is with enough power before shooting.

A - B trace record shooting

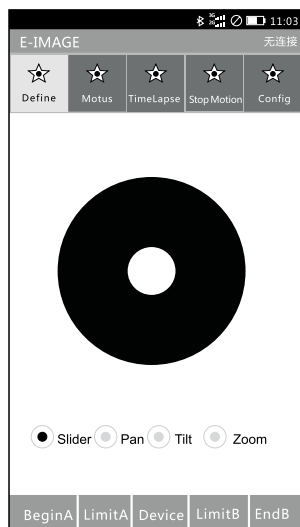

1. In the define interface, please select "slider" channel, to control the movement of slider.
2. Touch joystick, to control the camera move to your request beginning point, then click the "Begin A", the color of "Begin A" will change color from black to red.
3. Touch the joystick again, to control the camera move to your request ending point, then click the "Set B", the color of "Set B" will change color from black to red. AB trace is finished.

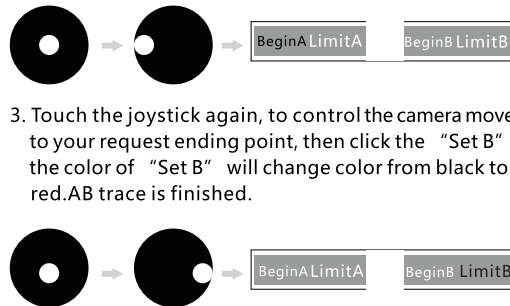

★ Note 1: if you want to record complex traces, please use the wireless motor CONTROLLER (optional) to do it.

Trace Motus

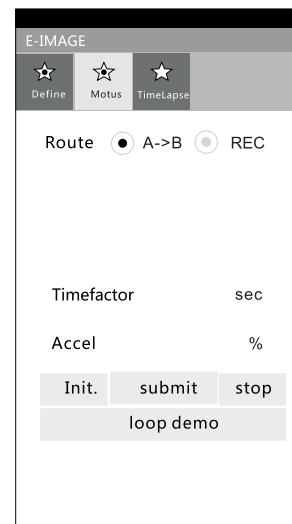

1. In the Define interface, please select "slider" channel, to control the movement of slider.
2. Touch joystick, to control the camera move to your request beginning point, then click the "BeginA", the color of "BeginA" will change color from black to red.
3. Touch the joystick again, to control the camera move to your request ending point, then click the "EndB", the color of "EndB" will change color from black to red.
AB trace is finished.

4. (1) Click ☐ A->B to set the time and acceleration.

Time factor	sec
Acceleration	%

- or (2) REC : Complicated trace only can be recorded by wireless remote CONTROLLER (optional). After trace record is finished, you will find there are at most 5 routes when you click the "REC". Please choose the record that you want to run, and then set up time and acceleration.

Route	<input type="radio"/> A->B	<input checked="" type="radio"/> REC
Route ID	<input type="radio"/> 0	<input checked="" type="radio"/> 1 <input type="radio"/> 2 <input type="radio"/> 3 <input type="radio"/> 4

5. Click the initialization, let the camera move back to the Begin A, and then click submit, make the camera to move from "A" to "B".

Init	submit
------	--------

loop demo

6. In order to preview the results repeatedly, please click the "loop", so the camera will move back and forth between AB point.

★ Note 1: Complicated trace only can be recorded by wireless remote CONTROLLER (optional). Please choose trace number on your APP to continue your following operations

Time-lapse

1. In the Define interface, please select "slider" channel, to control the movement of slider .
2. Touch joystick, to control the camera move to your request beginning point, then click the "BeginA" , the color of "BeginA" will change color from black to red.
3. Touch the joystick again, to control the camera move to your request ending point, then click the "EndB" , the color of "EndB" will change color from black to red.
AB trace is finished.
4. In time-lapse interface, please set the shooting number, exposure time, end date and time, the percentage of the waiting time and movement time.

5. Click the "init" , let the camera move back to the beginning point A, and then click "submit" , make the camera shoot according to the parameters that you set up.

6. Click "monitor", you could check the shooting process. Click "stop" , you could cancel the current operation.

★ Note 1: Complicated trace only can be recorded by wireless remote CONTROLLER(optional). Please choose trace number on your APP to continue your following operations

★ Note 2: APP exposure time set should follow the following rules:

- ① When camera is under M mode, the APP exposure time should be longer than the camera exposure time. For example, camera exposure time is 1/100 s, at this time the App exposure time should be equal or longer than 1/80 s.
- ② When camera is under B mode, the real exposure time is decided by APP, now, there is no special requirement for App exposure time.

Stop-Motion

1. In the Define interface, please select "slider" channel, to control the movement of slider .
2. Touch joystick, to control the camera move to your request beginning point, then click the "BeginA" , the color of "BeginA" will change color from black to red.
3. Touch the joystick again, to control the camera move to your request ending point, then click the "EndB" , the color of "EndB" will change color from black to red.
AB trace is finished. .
4. In the Stop-Motion interface, please set the photo quantity you want to take and exposure time

5. Click the "Submit" , following interface will appear. Click the initialization, let the camera move back to the beginning point A.

6. After adjustment of shot scenes and character' s actions, click the "SHOOT", the color of number will become red, it means this picture is finished. If white, it means no shooting. Please click "next" for following shooting.

★ Note 1: in the shooting process, if you find there are some photos are not satisfied, you could input the picture number, then click "Positioning", the camera will move to that picture position automatically, then re-shoot it.

★ Note 2: APP exposure time set should follow the following rules:

- ① When camera is under M mode, the APP exposure time should be longer than the camera exposure time. For example, camera exposure time is 1/100 s, at this time the App exposure time should be equal or longer than 1/80 s.
- ② When camera is under B mode, the real exposure time is decided by APP, now, there is no special requirement for App exposure time.

Wireless shutter channel Settings

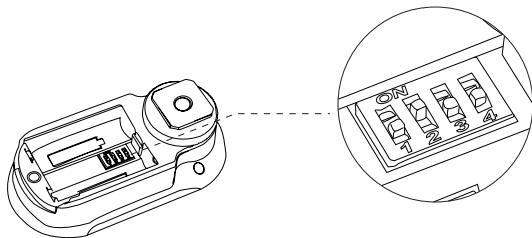

Switch1	Switch2	Switch3	Switch4	Channel
on	off	off	off	1
off	on	off	off	2 (factory setting)
off	off	on	off	3
off	off	off	on	4
off	off	off	off	5
on	on	off	off	6
off	on	on	off	7
off	off	on	on	8
on	on	on	off	9
off	on	on	on	10
on	on	on	on	11
on	off	on	off	12
off	on	off	on	13
on	off	off	on	14
on	off	on	on	15
on	on	off	on	16

Operation Modes

There are three operation modes for Eimage Motor: Quiet Mode, Stable Mode, Force mode
The motor need to be re-started if mode is changed.

Silent mode (If film in quite room, there is no noise could be heard when motor is working.
This mode is fitted for live recording.)

Silent mode could reduce the noises from motor working. Please enable it according to your actual request. For example, if film in quite scene, this mode is good. But when the slider is used on tiptilted angle, please change it to "standard" mode, as "Silent" mode could not provide precise movement because of shortage power.

Stable model (If film in common room, there is no noise could be heard when motor is working.
This mode is fitted for live recording)

It is suitable for the angel between slider and the horizontal is less than 30 °, and need big payload.

Force mode (If film in quite room, there is noise could be heard when motor is working. If shooting outside, this mode is fitted for live recording.)

Enable force mode to meet the requirements of large torque, high payload shooting scene. Force mode aples to vertical shooting scene. Please pay attention that in the mode, the movement speed should be not too fast, prevent idling motor

Maintenance

MAGIC MOTOR is precision electronic equipment and is not waterproof. Keep it away from sand and dust when in use. After use, it is recommended that you wipe the motor with a soft dry cloth. Never spray any cleaning liquids on to the motor.

Warranty and Support

MAGIC MOTOR enjoy 1 year of hardware warranty period. These service could be get from EIMAGE official dealers or contact with EIMAGE company directly.

Piratic risk Statement

If your APP show "your series No.is illegal,can't be used.Please contact E-IMAGE for LEGAL COPY",maybe the motor part is piratic.Please kindly make a note of that.

Troubleshooting

No.	Problem	Solution
1	App can't control the equipment	(1) Please check if the power of the device is on and the power is enough. (2) Please check if the aerial is installed. (3) Please check if the App is connected with the EIMAGE SLIDER successfully. If failed many times, please re-start the motor. (4) Please check if other mobile device has been already connected to the motor. (5) Please check if the 2.4G Channel is same, such as all in "2".
2	Picture shakes unusually	(1) Please lower the "Max. speed" and "Max. acceleration". (2) Please check the motor belt is in tight situation.
3	Equipment can't move forward in some point.	(1) Please check if Limited AB is set.
4	LIMIT AB can't be set up	(1) Please check whether the device is restart, if restarted, please set a new limit AB.
5	Three modes switching failure	(1) Restart the motor.
6	Motor noise is too big	(1) Please choose the operation mode to "Silent mode" Or "Stable mode".
7	The loading capacity is not enough	(1) Please select force mode and stable mode. Also please make sure the battery power is enough.

No.	Problem	Solution
8	Motor could be moved after power is switched on	(1) Please check if the knob of "speed and direction" on the zero calibration.
9	Alarm rings all the time after 10s of power on	(1) Please check the if battery power is enough, or the voltage is too low.
10	Wireless shutter is not lighted up when switched on	(1) Please check whether battery is installed or installation direction is right.
11	Wireless shutter could not respond	(1) Please check whether the shutter release is loose or the not plug in. (2) Please restart. (3) Please check whether the wireless shutter and APP are in the same channel.
12	If motor works too slowly even if App Joystick is in max. speed	(1) Please re-set the "max-speed config" & "max. Acceleration config" in CONFIG page, change it more than original set or more than 100. (2) Please check if current is less than 3A, voltage is less than 12V.

Specifications

Technical parameters

Speed range	0.01mm/s-200mm/s
Positioning accuracy	0.01mm
Max.load	8kg
The motor power	8-32w
Voltage range	12-24v
Use frequency	2.4G / Bluetooth
Communication distance	20m
Speed control mode	APP control, "Speed & direction" knob control or Remote Control (optional)
Acceleration control	Infinitely adjustable-speed

Product parameters

The basic parameters

Product size	170x125x110mm(without antenna)
The product weight	1500g(without packaging)
The product working environment temperature	-20°C~50°C , best working temperature 20°C~40°C

Max. load in three different operation mode

Quiet mode	10 kg in horizontal, 2.5 kg in vertical
Stable mode	12 kg in horizontal, 3.5 kg in vertical
Force mode	30 kg in horizontal, 8 kg in vertical

Peripheral equipment parameters

Battery	12-24V
Power adapter	12-24V
Electric current	>3A

The official QR code

For more information, please visit the EIMAGE official website:



EIMAGE official QR code



EIMAGE Wechat QR code

Contact Information

NINGBO EIMAGE EQUIPMENT CO., LTD

Address: No.373 South Hangyong Rd, Luotuo Industry Zone, Zhenhai, Ningbo, China. 315202

Telephone: 86-574-86590061, 86-574-86590031

Fax: 0574-86590078

E-mail: sales@eimagevideo.com; rory@eimagevideo.com

Website: www.eimagevideo.com

Note

[illegible]